

HEULIEZ

TECHNICAL DATA SHEET

High value

June 2020

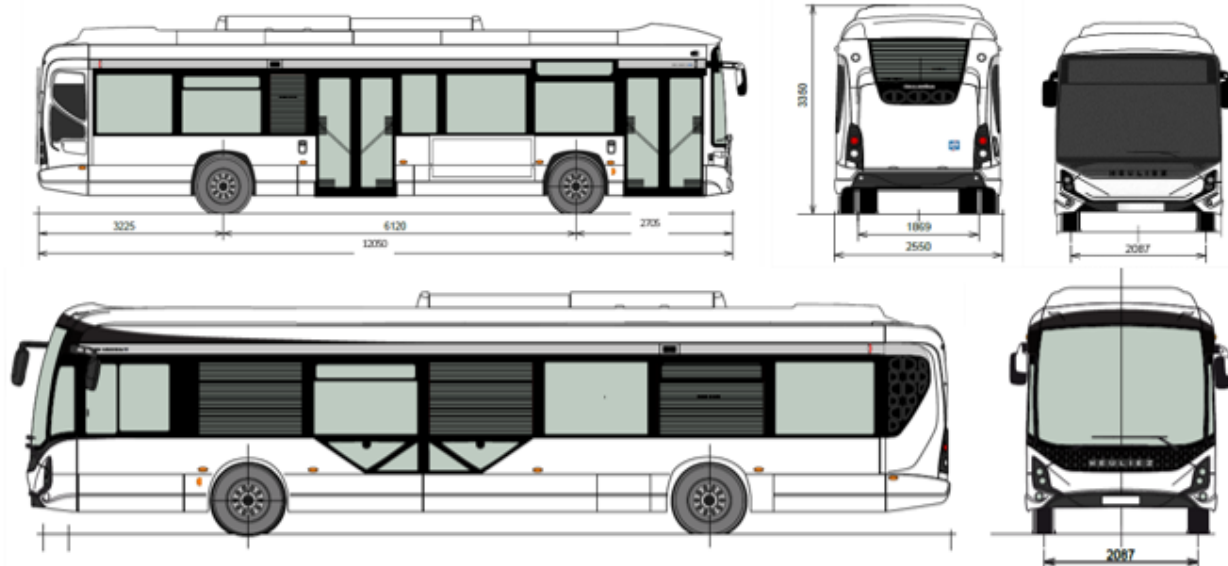

24 seats + “wheelchair” space (x) + driver

27 seats + “wheelchair” space (x) + driver

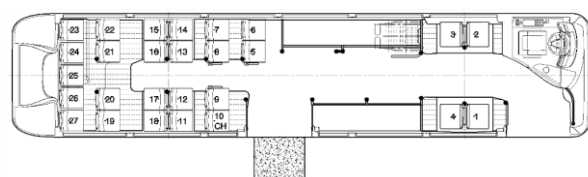
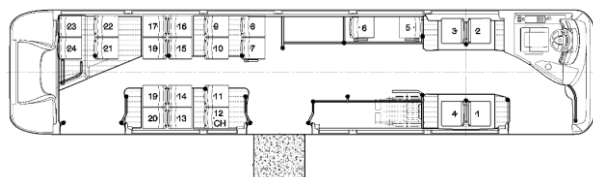

WEIGHTS

Gross kerb weight	according to equipment
G.V.W. max permitted weight	20 000 kg
on front axle	7 245 kg
on rear axle	13 000 kg

DIMENSIONS

Overall length	12.050 m
Front overhang	2.705 m
Wheelbase	6.120 m
Overall width	2.550 m
Total height, full load	3.246 m
Inside headroom (front part/rear part)	2.384/2.262 m
Slope of the floor (rear part only)	7,2 %
1 st step-height	
Front door	0.320 m
Center & rear door	0.330/0.340 m
Width of front / center / rear doors	1.200 m
Floor height	0.340 m
Ground clearance, under skirt	0.300 m
Front/rear tracking	2.087/1.869 m
Inner Turning radius	9.095 m
Outer Turning radius	10.890 m
Angle of attack / escape	7.4°/7.4°
Option : BRT version LINIUM (length)	12,275 m



For alternative layouts, please contact us

DRIVE LINE ENGINE

Transverse vertical position

Without the need for Exhaust Gas Recirculation (EGR) and without additional cooling requirements to reduce engine temperature.

Exhaust pipe in high position.

Fire detector in engine compartment.

IVECO TECTOR 7 6-cylinder diesel engine - 6,7 cc Euro VI step D with temperature and particles sensors COMMON RAIL injection	
Max. output	210 kW (286 HPDIN)
Max. torque	1 000 Nm at 1 250 rpm

SERIAL HYBRID STRUCTURE

Generator (140kW) produces electricity to charge the batteries and power the electric motor.

EDLC (Electric Double Layer Capacitor) ultra-caps - (0,82 kWh) 200 kW, store energy from braking recovery. Power the electric motor when accelerating.

fulfill the R100-02 regulation.

Permanent magnet electric engine of 120 kW /170 kW drives the rear axle.

“Arrive & Go “function diesel engine being cut off before bus stop. Arrival and departure from bus stop in full electric.

Braking energy recovery

Maximum speed: 77 Km/h

CHASSIS AND STRUCTURE - EXTERIOR TRIM

Self-supporting integral structure. Anti-corrosion treatment of chassis by cathophoretic immersion. Body structure consisting in 5 panels (front/rear/left/right/top) made of welded stainless-steel sections and sheet panels. Assembling of the 5 panels to the chassis by bolting. 12mm thick plywood floor, protected by phenolic resins on both sides and wax containing resins on ground side. Composite front and rear ends, roof and side panels. Bonded assembly. Gravel resistant protected wheel arches. Composite front and rear bumpers in 3 parts.

BRT options:

GX LINIUM front end

wheel covers.

ACCESS AND DOORS

2 or 3 inward swing/sliding doors. Both leaves of front door are double glazed. Electrical access ramp on the central door. Left and right self-de-frosting rear-view mirrors or motor driven and self-de-frosting rear-view mirrors with integrated flag holders.

GLAZING - HEATING – COOLING

TSA tinted or Shade-Lite panoramic laminated glass windscreen bonded on front face. Bonded side windows. Driver's window: sliding type in front part. TSA tinted glass all round or Grey 40 or Venus 35 tinted except driver's window, front door and rear window.

With or without triangular window on platform

Front heating/de-frosting unit used for driver's compartment (air from outside or re-circulated air). 4-speed control (power: 17 500 W). 1-off passenger heater (forced air, 7500 W) with 2 speeds controlled from the dashboard. Insulated roof.

2 air exhausters on rear part of the roof

With or without passenger and/or driver's compartment air conditioning

With or without additional heater in passenger compartment

With or without autonomous heater

With or without motor driven or hand actuated opaque or translucent roof hatches

With or without glazed roof: Lumi'Bus © module

DRIVER'S COMPARTMENT

Adjustable steering wheel (height and angle). Air-suspended driver's seat with adjustment control on right-hand side. VDV instrument panel with warning lamps and control display panel. Pivoting door, wall behind the driver with a glazed upper part. Interior rear-view mirrors. Left side and front sun visor. Driver's individual with 2 spotlights, luggage box. Average fuel consumption on dashboard.

Adjustable steering wheel and dashboard in height and in slope

With or without anti aggression gate

INTERIOR TRIM

« wheelchair and pram » space

Epoxy or stainless-steel stanchions and handrails.

High wear resistant floor covering up to plinths top. Laminated roof and side panels. Thermo-formed wheel arches. Polyester ceiling arches.

With or without fire extinguisher

ELECTRICAL EQUIPMENT

2-off 12 V 225 A/h maintenance-free batteries mounted on a sliding support located in an outside compartment at the vehicle front left-hand side.

Passenger compartment lighted by leds lights.

Door step lighting at door opening. Lighting of driver's compartment, paying position and steps. Electricity-saving system for intensive use whilst engine is off.

Thermal circuit-breakers.

Battery re-loading and engine start FENWICK socket

Rear lights with leds : parking lights, stop lights, fog lights, reverse lights and turning lights. Corner marker lights with leds.

FMS socket

4 passenger's loudspeakers and 1 driver loudspeaker and 1 outside loudspeaker

Preparation for front or lateral electronic destination indicator.

With or without flashing/stop indicators on the top of rear end.

With or without atmosphere lightings.

With or without complete radio equipment.

With or without monoring gong for pedestrian zone.

With or without Front fog lights

With or without 24 V plug in engine compartment

With or without ITXPT

FRONT AXLE

Front independent wheels.

REAR AXLE

ZF AV 133

Axle torque: 9.81 (13x40)

SUSPENSION

Constant height air suspension.

Kneeling and raising system (72 mm stroke) on vehicle right-hand side, controlled from the driving position.

COMPRESSED AIR

Pressure: 10 bars. 630 cm3 twin-cylinder air compressor.

Single tower air dryer.

Manual bleeding on the air tanks. Cyclone air cleaner. Oil separator.

BRAKES

Service brakes: air-controlled disc brakes at the front and at the rear. . ABS-ASR braking system. EBS braking system.

Parking brake and door brake controlled via separate circuits.

Pneumatic parking brake actuated by lack of air, spring chamber on rear wheels.

Service braking: electrical FAE

Brakes applied by opening of the central door.

FUEL TANK

Capacity: 300 liters + 54 liters of AdBlue additive. Tank filling spouts on vehicle rear right hand side.

WHEELS AND TYRES

Michelin or Bridgestone

275/70 R 22.5 tires at the front, twin tires at the rear.

With or without wheel covers.

CERTIFICATION

In accordance with the appendix 8 of the ECE R107 Regulation and with the appendix 11 of the decree of August 3rd, 2007

NOT CONTRACTUAL DOCUMENT.

THE MANUFACTURER RESERVES THE RIGHT TO MODIFY WITHOUT ADVANCE NOTICE THESE TECHNICAL SPECIFICATIONS. THE ADAPTATIONS CAN BE MADE ONLY FROM OUR DRAWINGS

Iveco France – 1 rue des Combats du 24 août 1944 – Porte E – 69200 Vénissieux (France)
SIREN 419 683 818 – RCS Lyon

